

Product: Plastic closure **AD Pharm - 28**

Closure material

Material	High Density Polyethylene HD-PE
Material Condition	Pellet form
Colorant additive	Color masterbatch

Closure characteristics

Outside diameter , mm	$\varnothing 30.3 \pm 0.3$
Height, mm	20.2 ± 0.2
Inside thread diameter, mm	$\varnothing 25.7 \pm 0.2$
Pitch of thread, mm	3.63 (7G/1")
Perforation line height, mm	14.4
TE band - inside diameter, mm	26.5 ± 0.2
Weight of the closure (without liner), g	2.77 ± 0.1

Liner

Liner material:	EPE
Liner sizes (diameter x thickness), mm	$25.9 \times 1.8 \pm 0.2$
Weight of the liner, g	0.24 ± 0.03

Recommended application

Recommended head pressure during application, N	25-70
Recommended closing torque during application, Nm	0.8 – 1.0

NOTE: These values are starting values and can be varied according to the results to be achieved.

Opening torques

Torque needed to start the closure rotation/slip torque, Nm	0.6 – 1.0
Torque needed to break the tamper evident band, brake torque, Nm	0.2 – 0.6

NOTE: It is possible immediately after application the slip torques to be higher than the values indicated in this specification sheet. The specified values are reached one week after application.

The removal torques depend on the particular application, on the torques applied by the capping heads, the type and the quality of the bottle neck finish, etc.

Closure Drawing

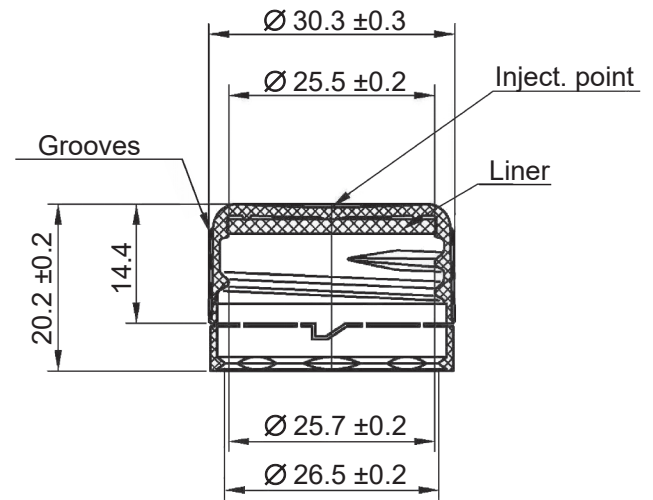

Relevant Bottle Neck Drawing

Relevant bottleneck drawing: 28 STD (CE.T.I.E. GME 30.06)

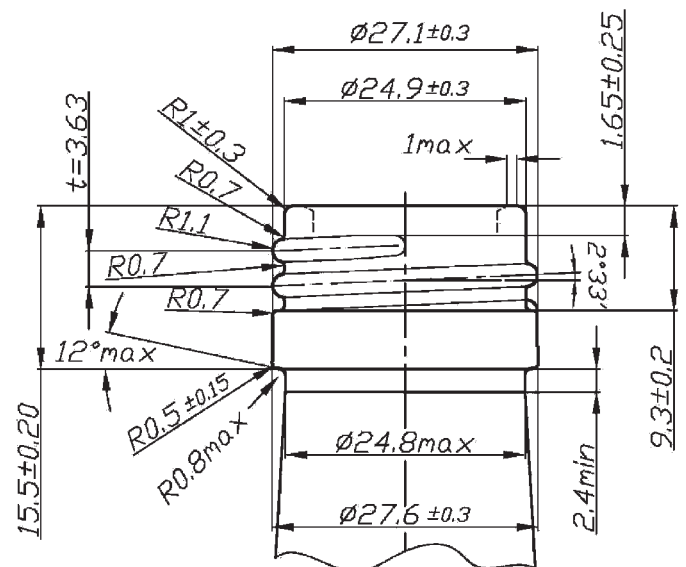

Packaging specification

Quantity, pcs.	4 200 pcs
Box Sizes, mm	600 x 400 x 370 mm
Cardboard Type	Corrugated five layer cardboard
Polyethylene Sack	Polyethylene –non-toxic, antistatic <100 ppm Pb, Cd, Hg, Cl⁶
Adhesive Strip (Scotch)	50 mm
Product Identification	Labeling

Pallet type – Euro pallet

Sizes
1200 x 800 x*

* Height of the pallet may vary with customers' requirements

Outside Packing

Stretch wrapped

Pallet identification

Labeling

NOTE: The closures shall be stored in well-ventilated area, away from direct sunlight, strong vapours and odours at temperatures 5°C -30°C for the period of 1 (one) year after the date of production. Within 24 hours before use, storage temperature of the products should not be below than 18°C and higher than 30°C. The closures should be sold following the principle "first to come-first to go" (FIFO). Pallets should not be double stacked.